

RÜCKSCHLAGVENTIL NON RETURN VALVE

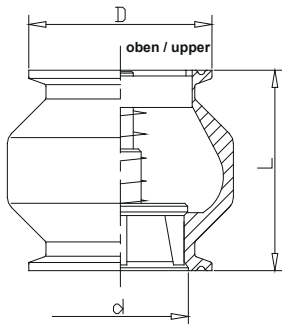

4-fach geführte metallische Tellerdichtung
4-way controlled metallic disc seal

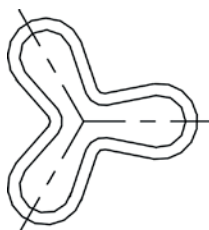
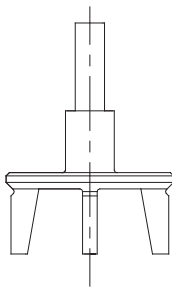

TC-CLAMP

Rückschlagventil, 2x TC-Clamp Non return valve, 2x TC-Clamp

DN	Typ Type	Ø d	Ø D	L	p [bar]
1"	25C63A	22,2	50,5	60	0,18
1,5"	38C63A	34,9	50,5	62	0,12
2"	51C63A	47,5	64	70	0,08
2,5"	63C63A	60,2	77,5	80	0,05
3"	76C63A	72,9	91	90	0,05
4"	102C63A	97,6	119	138	0,05

ERSATZTEILE FÜR TC-CLAMP SPAREPARTS FOR TC-CLAMP

4-fach geführte metallische Tellerdichtung 4-way controlled metallic disk seal

DN	Typ Type
1"	25SD621A
1,5"	38C632A
2"	51C632A
2,5"	63C632A
3"	76C632A
4"	102C632A

Feder, zylindrisch Spring, cylindric

DN	Typ Type
1"	25SD603B
1,5"	38-40SD603B
2"	50-51SD603B
2,5"	63-65SD603B
3"	76-80SD603B
4"	102S603B

Führungsring oben Upper guiding ring

DN	Typ Type
1"	25SD601Y
1,5"	38C633A
2"	51C633A
2,5"	63C633A
3"	76C633A
4"	102C633A